

Passat

Fitting Locations

No. 201 / 1

Edition 10.2006

Overview of fuses and relay locations

1 - Fuse holder A (SA)

□ ⇒ from page → 201/3

2 - Relay carrier under electronics box

□ ⇒ from page → 201/39

3 - Terminal 30 wiring junction

□ ⇒ from page → 201/47

4 - Heated windscreen relay

□ ⇒ from page → 201/49

5 - Fuses on left under dash panel

□ ⇒ from page → 201/42

6 - Fuse holder D (SD)

□ ⇒ from page → 201/31

7 - Relays on onboard supply control unit

□ ⇒ from page → 201/43

8 - Fuse holder F (SF)

□ ⇒ from page → 201/45

9 - Fuse

□ ⇒ from page → 201/48

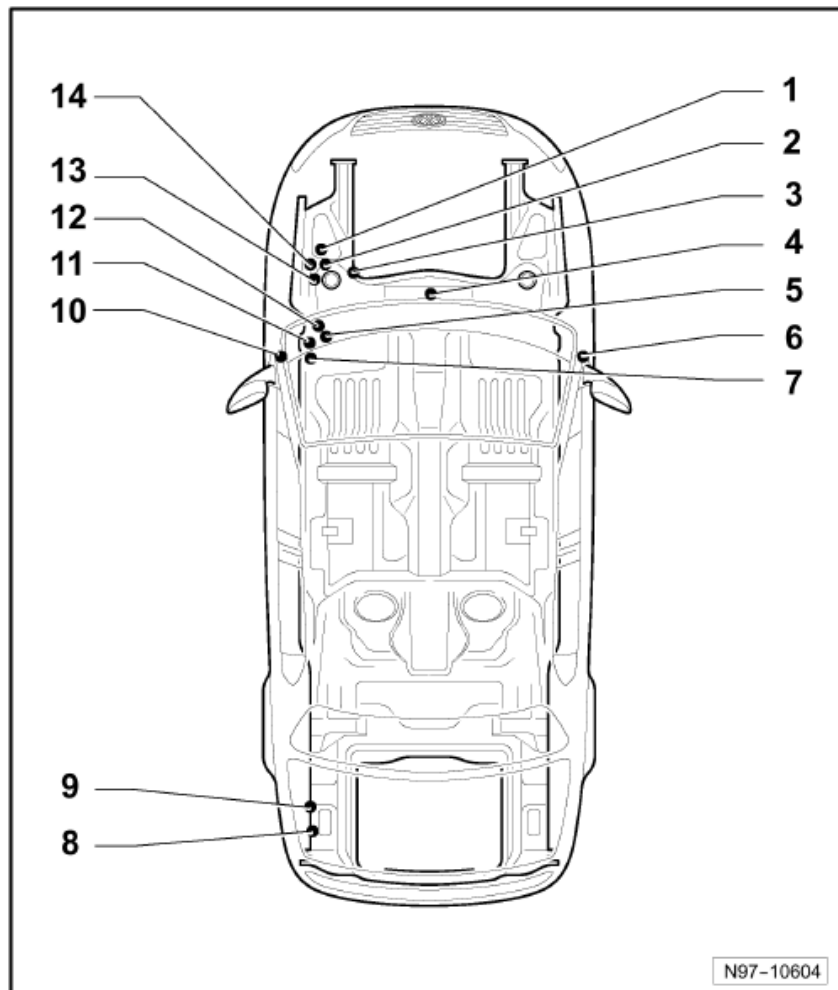

Passat

Fitting Locations

No. 201 / 2

10 - Fuse holder C (SC)

□ ⇒ from page → 201/25

11 - Relay carrier 1 on left under dash panel

□ ⇒ from page → 201/41

12 - Relay carrier 2 on left under dash panel

□ ⇒ from page → 201/44

13 - Relay locations on electronics box

□ ⇒ from page → 201/37

14 - Fuse holder B (SB)

□ ⇒ from page → 201/7

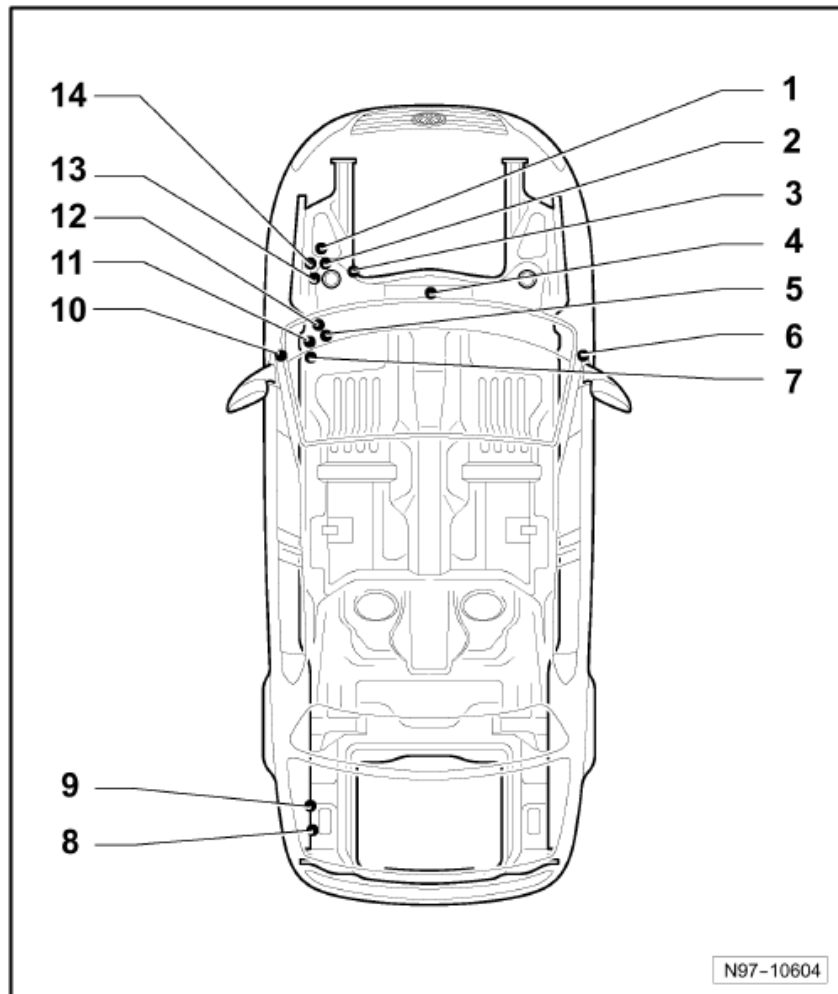

Passat

Fitting Locations

No. 201 / 3

**Fuses (SA) on fuse holder on electronics box,
in left engine compartment (box high)**

Torque settings

⇒ Electrical system, Repair Group 97, Removing and
installing fuse holders

Fuse colours

- 30 A - green
- 25 A - white
- 20 A - yellow
- 15 A - blue
- 10 A - red
- 7,5 A - brown
- 5 A - beige
- 3 A - purple

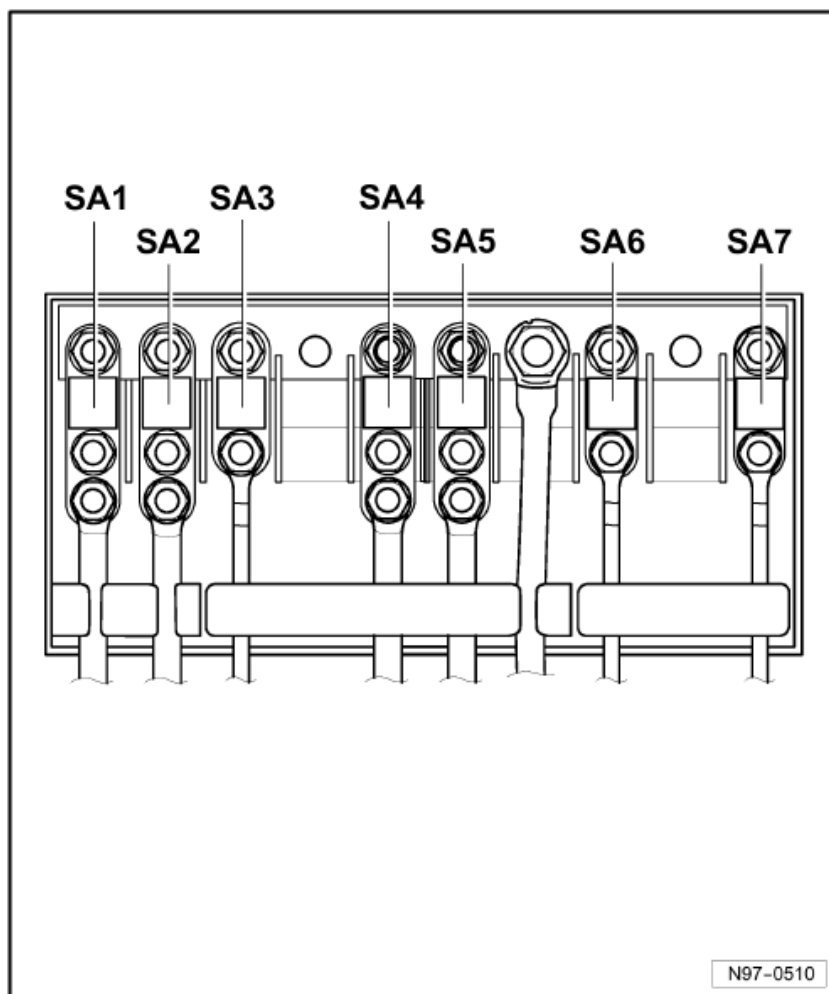

Passat**Fitting Locations****No. 201 / 4**

No.	Current Flow Diagram designation	Nominal value	Function/component	Terminal
1	- SA1 - Fuse 1 on fuse holder A	150A 180A*	- C -Alternator	30
2	- SA2 - Fuse 2 on fuse holder A	80A	- V187-Electromechanical power steering motor	30
3	- SA3 - Fuse 3 on fuse holder A	80A 50A **	- J293-Radiator fan control unit	30
4	- SA4-Fuse 4 on fuse holder A	100A **** 80A ***	- - Auxiliary fuse on relay carrier (S44 and S46) **** - Left fuse carrier (SC32 - SC37) **** - Right fuse carrier (SD32 - SD37) **** - Left fuse carrier (SC12 - SC17, SC29 - SC31) *** - Right fuse carrier (SD12 - SD17, SD28, SD29 - SD31) ***	30
5	- SA5 - Fuse 5 on fuse holder A	80A	- - Right fuse carrier (SD22 - SD27) - Auxiliary fuse on relay carrier (S44 and S46) ***	30
6	- SA6-Fuse 6 on fuse holder A	100A **** 80A ***	- - Left fuse carrier (SC12 - SC17, SC29 - SC31) **** - Right fuse carrier (SD12 - SD17, SD28, SD29 - SD31) **** - Left fuse carrier (SC32 - SC37) ***	30
7	- SA7-Fuse 8 on fuse holder A	40A	- J104 -ABS control unit	30

* - models with 180A alternator only, installed in alternator wire

** - only models from November 2005

*** - only models from May 2006

**** - only models up to April 2006

Passat

Fitting Locations

No. 201 / 5

**Fuses (SA) on fuse holder on electronics box,
in left engine compartment (box low)**

Torque settings

⇒ Electrical system, Repair Group 97, Removing and
installing fuse holders

Fuse colours

- 30 A - green
- 25 A - white
- 20 A - yellow
- 15 A - blue
- 10 A - red
- 7,5 A - brown
- 5 A - beige
- 3 A - purple

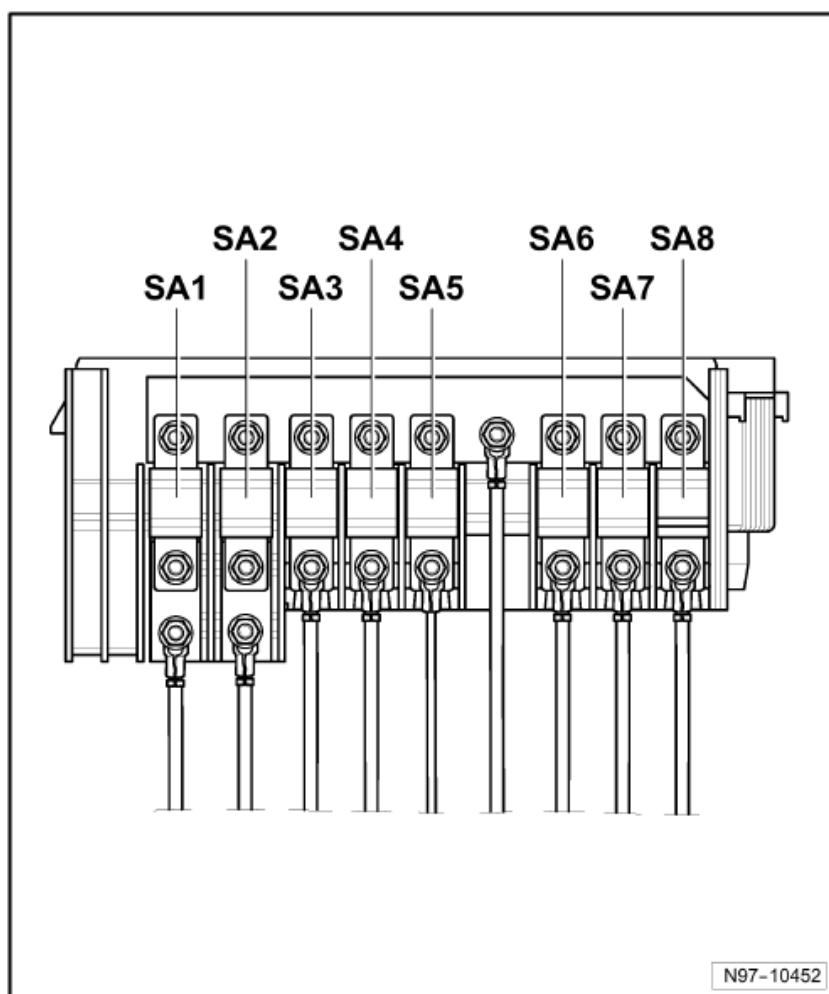

Passat**Fitting Locations****No. 201 / 6**

No.	Current Flow Diagram designation	Nominal value	Function/component	Terminal
1	- SA1 - Fuse 1 on fuse holder A	150A	- C -Alternator	30
2	- SA2 - Fuse 2 on fuse holder A	80A	- V187-Electromechanical power steering motor	30
3	- SA3 - Fuse 3 on fuse holder A	50A* 80A	- J293-Radiator fan control unit	30
4	- SA4-Fuse 4 on fuse holder A	100A	- - Auxiliary fuse on relay carrier (S44 and S46) *** - Left fuse carrier (SC32 - SC37) *** - Right fuse carrier (SD32 - SD37) *** - Left fuse carrier (SC12 - SC17, SC29 - SC31) ** - Right fuse carrier (SD12 - SD17, SD28, SD29 - SD31) **	30
5	- SA5 - Fuse 5 on fuse holder A	80A	- - Right fuse carrier (SD22 - SD27) - Auxiliary fuse on relay carrier (S44 and S46) **	30
6	- SA6-Fuse 6 on fuse holder A	100A *** 80A **	- - Left fuse carrier (SC12 - SC17, SC29 - SC31) *** - Right fuse carrier (SD12 - SD17, SD28, SD29 - SD31) *** - Left fuse carrier (SC32 - SC37) **	30
7	- SA7-Fuse 7 on fuse holder A	60A 100A	- -Charging line second battery Z35 -Auxiliary heater element	30
8	- SA8 - Fuse 8 on fuse holder A	40A	- J104 -ABS control unit	30

* - only models from November 2005

** - only models from May 2006

*** - only models up to April 2006

Passat**Fitting Locations****No. 201 / 7**

Fuses (SB) on electronics box, left engine compartment (not for AXX, AXZ, BKX, BLV, BPY, BWA) up to 04.2005

Fuse colours

- 30 A - green
- 25 A - white
- 20 A - yellow
- 15 A - blue
- 10 A - red
- 7,5 A - brown
- 5 A - beige
- 3 A - purple

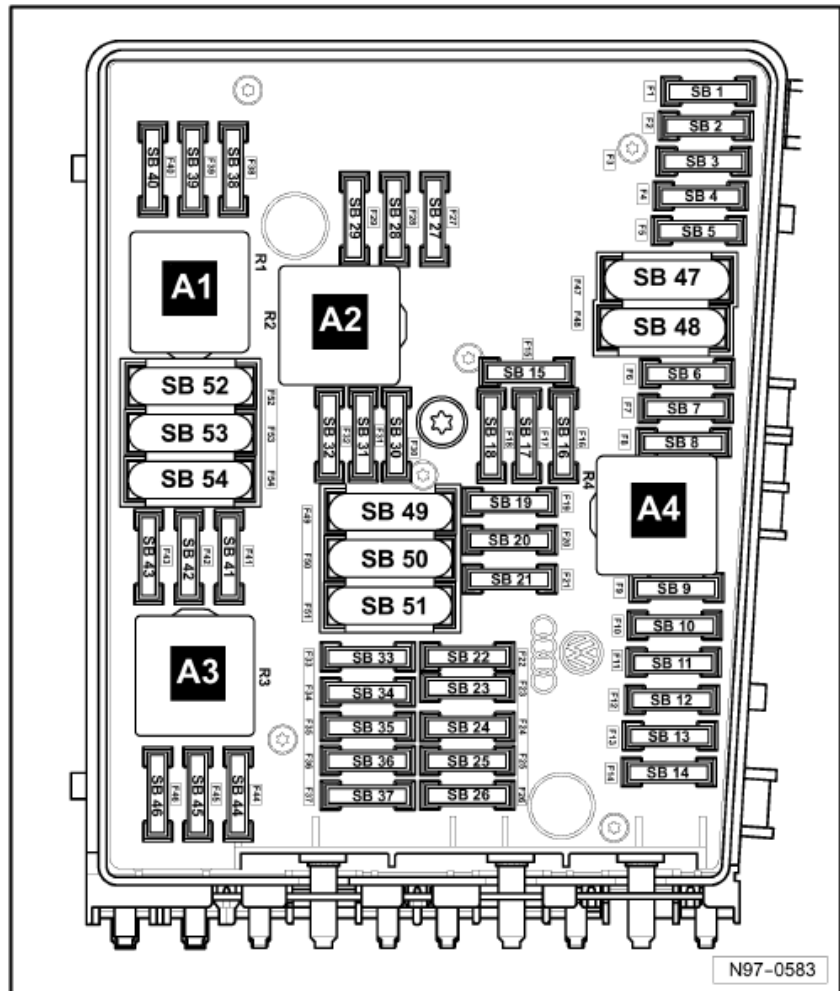

Passat**Fitting Locations****No. 201 / 8**

No.		Current Flow Diagram designation	Nominal value	Function/component	Terminal
F1	-	SB1 - Fuse 1 on fuse holder B	5A 15A	- J217-Automatic gearbox control unit J743-Mechatronics for double clutch gearbox	30
F2	-	SB2 - Fuse 2 on fuse holder B	30A	- J104 -ABS control unit	30
F3	-	SB3 - Fuse 3 on fuse holder B	20A	- J393-Convenience system central control unit	30
F4	-	SB4 - Fuse 4 on fuse holder B	5A	- J519-Onboard power supply control unit	30
F5	-	SB5 - Fuse 5 on fuse holder B	20A	- H2 -Treble tone horn H7 -Bass tone horn	30
F6	-	SB6 - Fuse 6 on fuse holder B		- -Vacant	30
F7	-	SB7 - Fuse 7 on fuse holder B		- -Vacant	30
F8	-	SB8 - Fuse 8 on fuse holder B		- -Vacant	87
F9	-	SB9 - Fuse 9 on fuse holder B		- -Vacant	87
F10	-	SB10 - Fuse 10 on fuse holder B		- -Vacant	87
F11	-	SB11 - Fuse 11 on fuse holder B		- -Vacant	87
F12	-	SB12 - Fuse 12 on fuse holder B		- -Vacant	87
F13	-	SB13 - Fuse 13 on fuse holder B		- -Vacant	30
F14	-	SB14 - Fuse 14 on fuse holder B		- -Vacant	30
F15	-	SB15 - Fuse 15 on fuse holder B		- -Vacant	87

Passat**Fitting Locations****No. 201 / 9**

No.	Current Flow Diagram designation	Nominal value	Function/component	Terminal
F16	- SB16 - Fuse 16 on fuse holder B	10A	- J527-Steering column electronics control unit	30
F17	- SB17 - Fuse 17 on fuse holder B	5A	- J285 - Control unit in dash panel insert	30
F18	- SB18 - Fuse 18 on fuse holder B	30A	- R12 -Amplifier J608-Special vehicle control unit	30
F19	- SB19 - Fuse 19 on fuse holder B	15A	- R - Radio J503 - Control unit with display for radio and navigation system J506 - Control unit with display for TV, radio navigation (Japan)	30
F20	- SB20 - Fuse 20 on fuse holder B	5A	- J515-Aerial selection control unit J412-Mobile telephone operating electronics control unit	30
F21	- SB21 - Fuse 21 on fuse holder B		- -Vacant	30
F22	- SB22 - Fuse 22 on fuse holder B		- -Vacant	30
F23	- SB23 - Fuse 23 on fuse holder B	10A	- J329 -Terminal 15 voltage supply relay J623 -Engine control unit (BLF, BLR, BLY, BVY, BVZ)	30
F24	- SB24 - Fuse 24 on fuse holder B	10A	- J533-Data bus diagnostic interface	30
F25	- SB25 - Fuse 25 on fuse holder B		- -Vacant	30
F26	- SB26 - Fuse 26 on fuse holder B	10A	- J317-Terminal 30 voltage supply relay	30

Passat**Fitting Locations****No. 201 / 10**

No.	Current Flow Diagram designation	Nominal value	Function/component	Terminal
F27	- SB27 - Fuse 27 on fuse holder B	20A 10A*	- N...-Ignition coils with output stage (cyl. 1 - 4) (BLF, BLR, BLY, BVY, BVZ) N152-Ignition transformer (BSE, BSF) J49 -Electric fuel pump 2 relay (BKC, BMP) J179 -Automatic glow period control unit (BKC, BMP, BMA, BKP, BLS)	87
F28	- SB28 - Fuse 28 on fuse holder B	25A 30A*	- J623-Engine control unit	87
F29	- SB29 - Fuse 29 on fuse holder B	15A 10A*	- J299-Secondary air pump relay (BSE, BSF) N18-Exhaust gas recirculation valve (BKC, BKP, BMA) N75-Charge pressure control solenoid valve (BKC, BMP, BKP, BMA, BLS) N345-Exhaust gas recirculation cooler change-over valve (BKC, BMP, BKP, BMA, BLS) Z19-Lambda probe heater (BLF, BLR, BLY, BVY, BVZ) Z28-Lambda probe 2 heater (BLR, BVY, BVZ) Z29-Lambda probe 1 heater after catalytic converter (BLF)	87
F30	- SB30 - Fuse 30 on fuse holder B	20A	- J364 -Auxiliary heater control unit	30
F31	- SB31 - Fuse 31 on fuse holder B	30A	- J400-Wiper motor control unit	30
F32	- SB32 - Fuse 32 on fuse holder B		- -Vacant	87
F33	- SB33 - Fuse 33 on fuse holder B		- -Vacant	87

* - diesel engines only

Passat**Fitting Locations****No. 201 / 11**

No.	Current Flow Diagram designation	Nominal value	Function/component	Terminal
F34	- SB34 - Fuse 34 on fuse holder B		- -Vacant	87
F35	- SB35 - Fuse 35 on fuse holder B		- -Vacant	30
F36	- SB36 - Fuse 36 on fuse holder B		- -Vacant	30
F37	- SB37 - Fuse 37 on fuse holder B		- -Vacant	30
F38	- SB38 - Fuse 38 on fuse holder B	10A	- J293-Radiator fan control unit F265-Map-controlled engine cooling system thermostat (BLY, BLR, BVY, BVZ) N18-Exhaust gas recirculation valve (BSE, BSF) N80-Active charcoal filter system solenoid valve 1 (BLF, BLR, BLY, BSE, BSF, BVY, BVZ) N205-Inlet camshaft control valve 1 (BLF, BLR, BLY, BVY, BVZ) N316-Intake manifold flap valve (BLF, BLR, BLY, BSE, BSF, BVY, BVZ) V157-Intake manifold flap motore (BKC, BKP, BMA)	87
F39	- SB39 - Fuse 39 on fuse holder B	15A	- N276 -Fuel pressure regulating valve (BLF, BLR, BLY, BVY, BVZ) G476 -Clutch position sender (BLF, BKC, BMP, BKP, BMA, BLS)	87

Passat**Fitting Locations****No. 201 / 12**

No.	Current Flow Diagram designation	Nominal value	Function/component	Terminal
F40	- SB40 - Fuse 40 on fuse holder B	15A 10A*	- J583-NOx sensor control unit (BLR, BLY, BVY, BVZ) Z19-Lambda probe heater (BMP, BLS, BSE, BSF) Z29-Lambda probe 1 heater after catalytic converter (BLR, BLY, BSE, BSF, BVY, BVZ) Z30-Lambda probe 2 heater after catalytic converter (BLR, BVY) Z64-Lambda probe heater 3, after catalytic converter (BLR, BLY, BVY, BVZ)	87
F41	- SB41 - Fuse 41 on fuse holder B		- -Vacant	
F42	- SB42 - Fuse 42 on fuse holder B		- -Vacant	
F43	- SB43 - Fuse 43 on fuse holder B		- -Vacant	
F44	- SB44 - Fuse 44 on fuse holder B		- -Vacant	
F45	- SB45 - Fuse 45 on fuse holder B		- -Vacant	
F46	- SB46 - Fuse 46 on fuse holder B		- -Vacant	
F47	- SB47 - Fuse 47 on fuse holder B	40A	- J519-Onboard supply control unit, Right side light bulb, Left headlight dipped beam bulb, Left main beam bulb, Left tail light bulb (outer illumination ring), Right tail light bulb (inner illumination ring)	30

* - diesel engines and engine code BLY only

Passat**Fitting Locations****No. 201 / 13**

No.	Current Flow Diagram designation	Nominal value	Function/component	Terminal
F48	- SB48 - Fuse 48 on fuse holder B	40A	- J519-Onboard supply control unit, Left side light bulb, Right headlight dipped beam bulb, Right main beam bulb, Right tail light bulb (outer illumination ring), Left tail light bulb (inner illumination ring)	30
F49	- SB49 - Fuse 49 on fuse holder B	50A	- J519-Onboard supply control unit (terminal 15 supply)	30
F50	- SB50 - Fuse 50 on fuse holder B	60A	- J713-Second battery charging circuit relay	30
F51	- SB51 - Fuse 51 on fuse holder B		- -Vacant	
F52	- SB52 - Fuse 52 on fuse holder B	60A	- Z2 -Heated windscreen	30
F53	- SB53 - Fuse 53 on fuse holder B	50A	- J519-Onboard supply control unit (terminal 75 supply) Left fuse carrier (SC40 - SC42, SD39)	30
F54	- SB54 - Fuse 54 on fuse holder B	50A	- J179-Automatic glow period control unit (BMA, BMP, BKC, BKP, BLS) V101-Secondary air pump motor (BSE, BSF)	30

Passat**Fitting Locations****No. 201 / 14**

Fuses (SB) on electronics box, on left of engine compartment (box high)

Fuse colours

- 30 A - green
- 25 A - white
- 20 A - yellow
- 15 A - blue
- 10 A - red
- 7,5 A - brown
- 5 A - beige
- 3 A - purple

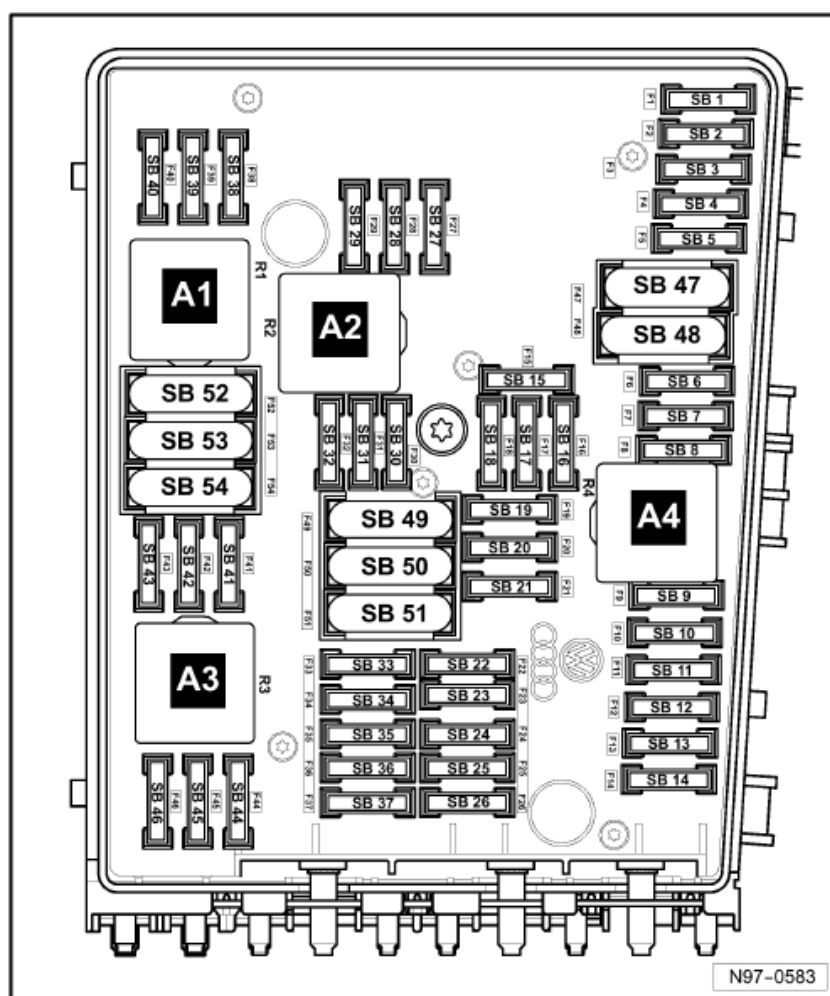

Passat**Fitting Locations****No. 201 / 15**

No.	Current Flow Diagram designation	Nominal value	Function/component	Terminal
F1	- SB1 - Fuse 1 on fuse holder B	5A 15A	- J217-Automatic gearbox control unit J743-Mechatronics for double clutch gearbox	30
F2	- SB2 - Fuse 2 on fuse holder B	30A	- J104 -ABS control unit	30
F3	- SB3 - Fuse 3 on fuse holder B	20A	- J393 - Convenience system central control unit (up to April 2006) J345 - Trailer detector control unit (from May 2006)	30
F4	- SB4 - Fuse 4 on fuse holder B	5A	- J519-Onboard power supply control unit	30
F5	- SB5 - Fuse 5 on fuse holder B	20A	- H2 -Treble tone horn H7 -Bass tone horn	30
F6	- SB6 - Fuse 6 on fuse holder B	20A	- N...-Ignition coils with output stage (AXX, AXZ, BPY, BLV, BWA)	87
F7	- SB7 - Fuse 7 on fuse holder B	15A 5A	- N276 -Fuel pressure regulating valve (AXZ, BLV) G476 -Clutch position sender (AXX, BPY, BWA)	87
F8	- SB8 - Fuse 8 on fuse holder B	10A	- J293 -Radiator fan control unit N80 -Active charcoal filter system solenoid valve 1 (AXZ, BLV) N205-Inlet camshaft control valve 1 (AXZ, AXX, BLV, BPY, BWA) N316-Intake manifold flap valve (AXZ, BLV) N318-Exhaust camshaft control valve 1 (AXZ, BLV) N401-Suction jet pump valve (AXZ, BLV) V157-Intake manifold flap motor (BKX)	87
F9	- SB9 - Fuse 9 on fuse holder B	5A 10A*	- J160 -Circulation pump relay (AXX, AXZ, BLV, BPY, BWA) J49 -Electric fuel pump 2 relay (BKX) J52 -Glow plug relay (BKX)	87
F10	- SB10 - Fuse 10 on fuse holder B	5A 10A*	- J670-Motronic current supply relay 2 (AXX, BPY, BWA)	87

* - diesel engines only

Passat**Fitting Locations****No. 201 / 16**

No.	Current Flow Diagram designation	Nominal value	Function/component	Terminal
F11	- SB11 - Fuse 11 on fuse holder B	25A 30A*	- J623-Engine control unit	87
F12	- SB12 - Fuse 12 on fuse holder B	10A	- G39 -Lambda probe (BKX)	87
F13	- SB13 - Fuse 13 on fuse holder B	5A	- G197 - Magnetic field sender for compass	30
F14	- SB14 - Fuse 14 on fuse holder B		- -Vacant	
F15	- SB15 - Fuse 15 on fuse holder B	10A	- V55 -Circulation pump (AXZ, AXX, BPY, BLV, BWA)	87
F16	- SB16 - Fuse 16 on fuse holder B	5A	- J527-Steering column electronics control unit	30
F17	- SB17 - Fuse 17 on fuse holder B	5A	- J285 - Control unit in dash panel insert	30
F18	- SB18 - Fuse 18 on fuse holder B	30A	- R12-Amplifier J608-Special vehicle control unit (Taxi, police)	30
F19	- SB19 - Fuse 19 on fuse holder B	15A	- R - Radio J503 - Control unit with display for radio and navigation system J506 - Control unit with display for TV, radio navigation (Japan)	30
F20	- SB20 - Fuse 20 on fuse holder B	5A	- J515 - Aerial selection control unit (up to April 2006) R36 - Telephone transmitter and receiver unit (up to April 2006) E508 - Operating unit for preparation for mobile telephone (from May 2006) J412 - Mobile telephone operating electronics control unit (from May 2006)	30

* - diesel engines only

Passat**Fitting Locations****No. 201 / 17**

No.	Current Flow Diagram designation	Nominal value	Function/component	Terminal
F21	- SB21 - Fuse 21 on fuse holder B	10A	- R78-TV-tuner R190-Digital satellite radio tuner	30
F22	- SB22 - Fuse 22 on fuse holder B	7.5A	- J650 -Multimedia control unit	30
F23	- SB23 - Fuse 23 on fuse holder B	10A	- J293-Radiator fan control unit	30
F24	- SB24 - Fuse 24 on fuse holder B	10A	- J533-Data bus diagnostic interface	30
F25	- SB25 - Fuse 25 on fuse holder B		- -Vacant	
F26	- SB26 - Fuse 26 on fuse holder B	10A	- J271-Motronic current supply relay (AXX, AXZ, BLV, BPY, BWA) J623-Engine control unit (not for BKX)	30
F27	- SB27 - Fuse 27 on fuse holder B		- -Vacant	
F28	- SB28 - Fuse 28 on fuse holder B		- -Vacant	
F29	- SB29 - Fuse 29 on fuse holder B		- -Vacant	
F30	- SB30 - Fuse 30 on fuse holder B	20A	- J364 -Auxiliary heater control unit	30
F31	- SB31 - Fuse 31 on fuse holder B	30A	- V -Windscreen wiper motor	30

Passat**Fitting Locations****No. 201 / 18**

No.	Current Flow Diagram designation	Nominal value	Function/component	Terminal
F32	- SB32 - Fuse 32 on fuse holder B	10A	- N75 -Charge pressure control solenoid valve (AXX, BPY, BWA) N80 -Active charcoal filter system solenoid valve 1 (AXX, BPY, BWA) N249-Turbocharger air recirculation valve (AXX, BPY, BWA)	87
F33	- SB33 - Fuse 33 on fuse holder B	15A	- N276-Fuel pressure regulating valve (AXX, BPY, BWA) Z19-Lambda probe heater (AXZ, BLV) Z28-Lambda probe 2 heater(AXZ, BLV)	87
F34	- SB34 - Fuse 34 on fuse holder B		- -Vacant	
F35	- SB35 - Fuse 35 on fuse holder B		- -Vacant	
F36	- SB36 - Fuse 36 on fuse holder B		- -Vacant	
F37	- SB37 - Fuse 37 on fuse holder B		- -Vacant	
F38	- SB38 - Fuse 38 on fuse holder B		- -Vacant	
F39	- SB39 - Fuse 39 on fuse holder B		- -Vacant	
F40	- SB40 - Fuse 40 on fuse holder B		- -Vacant	
F41	- SB41 - Fuse 41 on fuse holder B		- -Vacant	
F42	- SB42 - Fuse 42 on fuse holder B		- -Vacant	
F43	- SB43 - Fuse 43 on fuse holder B		- -Vacant	
F44	- SB44 - Fuse 44 on fuse holder B	10A	- V144-Fuel system diagnostic pump (AXZ, BLV, BPY)	87

Passat**Fitting Locations****No. 201 / 19**

No.	Current Flow Diagram designation	Nominal value	Function/component	Terminal
F45	- SB45 - Fuse 45 on fuse holder B	10A	- Z19-Lambda probe heater (AXX, BPY, BWA) Z29-Lambda probe 1 heater after catalytic converter (AXZ, BLV) Z30-Lambda probe 2 heater after catalytic converter (AXZ, BLV) Z92-Heating for lambda probe 3 for bank 1 (AXZ, BLV) Z93-Heating for lambda probe 3 for bank 2 (AXZ, BLV)	87
F46	- SB46 - Fuse 46 on fuse holder B	10A	- Z29-Lambda probe 1 heater after catalytic converter (AXX, BPY, BWA)	87
F47	- SB47 - Fuse 47 on fuse holder B	40A	- J519-Onboard supply control unit, Right side light bulb, Left headlight dipped beam bulb, Left tail light bulb (outer illumination ring), Right tail light bulb (inner illumination ring)	30
F48	- SB48 - Fuse 48 on fuse holder B	40A	- J519-Onboard supply control unit, Left side light bulb, Right headlight dipped beam bulb, Right tail light bulb (outer illumination ring), Left tail light bulb (inner illumination ring)	30
F49	- SB49 - Fuse 49 on fuse holder B	50A	- J519-Onboard supply control unit (terminal 15 supply)	30
F50	- SB50 - Fuse 50 on fuse holder B	60A	- J713-Second battery charging circuit relay	30
F51	- SB51 - Fuse 51 on fuse holder B		- -Vacant	
F52	- SB52 - Fuse 52 on fuse holder B	60A	- Z2 -Heated windscreen	30
F53	- SB53 - Fuse 53 on fuse holder B	50A	- J519-Onboard supply control unit (terminal 75 supply) -Left fuse carrier (SC40 - SC42, SD39)	30
F54	- SB54 - Fuse 54 on fuse holder B	50A	- J52-Glow plug relay (BKX)	30

Passat**Fitting Locations****No. 201 / 20**

Fuses (SB) on electronics box, on left of engine compartment (box low), from 05.2005

Fuse colours

- 30 A - green
- 25 A - white
- 20 A - yellow
- 15 A - blue
- 10 A - red
- 7,5 A - brown
- 5 A - beige
- 3 A - purple

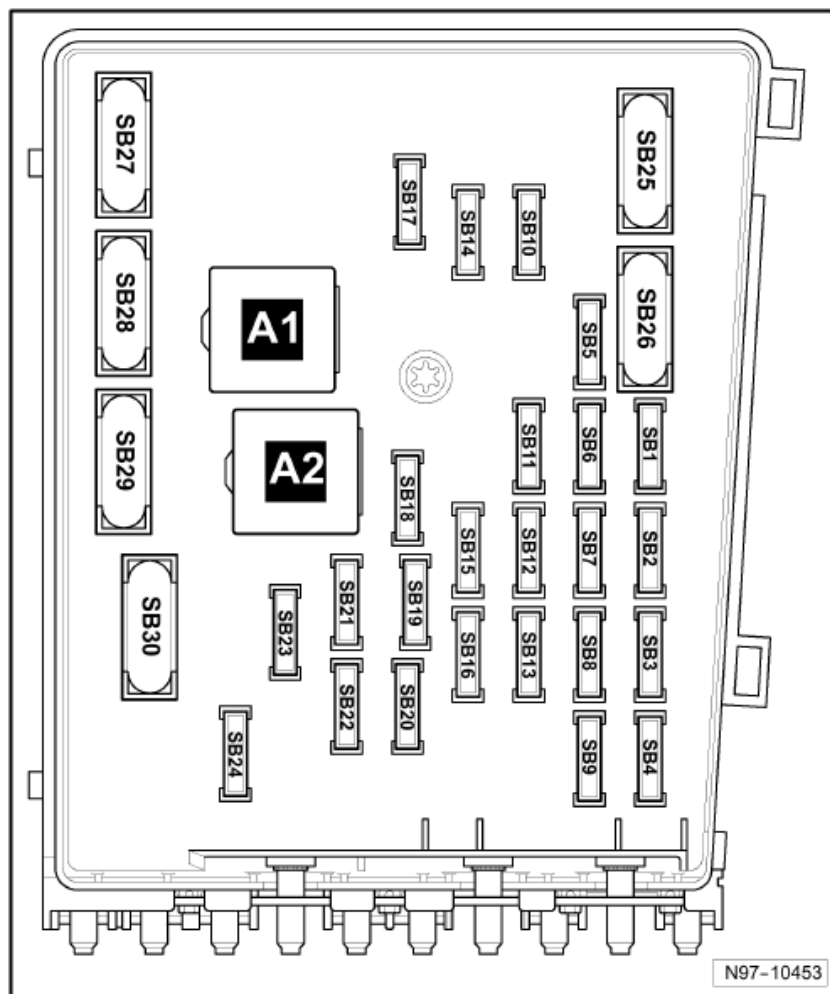

Passat**Fitting Locations****No. 201 / 21**

No.	Current Flow Diagram designation	Nominal value	Function/component	Terminal
F1	- SB1 - Fuse 1 on fuse holder B	7.5A	- J650 -Multimedia control unit	30
F2	- SB2 - Fuse 2 on fuse holder B	30A	- J104 -ABS control unit	30
F3	- SB3 - Fuse 3 on fuse holder B	20A	- J519-Onboard power supply control unit	30
F4	- SB4 - Fuse 4 on fuse holder B	20A 25A	- J393 - Convenience system central control unit (up to April 2006) J345 - Trailer detector control unit (from May 2006)	30
F5	- SB5 - Fuse 5 on fuse holder B	5A	- J519-Onboard power supply control unit	30
F6	- SB6 - Fuse 6 on fuse holder B	5A 15A	- J217-Automatic gearbox control unit J743-Mechatronics for double clutch gearbox (BMP, BKP, BMA, BVE, BVW)	30
F7	- SB7 - Fuse 7 on fuse holder B	15A	- J503 - Control unit with display for radio and navigation system R - Radio J506 - Control unit with display for TV, radio navigation (Japan)	30
F8	- SB8 - Fuse 8 on fuse holder B		- -Vacant	
F9	- SB9 - Fuse 9 on fuse holder B	5A	- J527-Steering column electronics control unit	30
F10	- SB10 - Fuse 10 on fuse holder B	20A	- J17-Fuel pump relay* J179-Automatic glow period control unit* N..-Ignition coils with output stage (cyl. 1 - 4) (BLF, BLR, BLX, BLY, BSE, BSF, BVX, BVY, BVZ)	87
F11	- SB11 - Fuse 11 on fuse holder B	5A	- J285 - Control unit in dash panel insert	30
F12	- SB12 - Fuse 12 on fuse holder B	5A	- J412 - Mobile telephone operating electronics control unit J515 - Aerial selection control unit (up to April 2006) E508 - Operating unit for preparation for mobile telephone (from May 2006)	30

* - diesel engines only

Passat**Fitting Locations****No. 201 / 22**

No.	Current Flow Diagram designation	Nominal value	Function/component	Terminal
F13	- SB13 - Fuse 13 on fuse holder B	10A	- J271-Motronic current supply relay J317-Terminal 30 voltage supply relay (BMP, BKC, BMA, BKP, BVE, BVW, BLS, BMR, BUZ) J623 -Engine control unit (BLF, BLR, BLX, BLY, BVX, BVY, BVZ)	30
F14	- SB14 - Fuse 14 on fuse holder B	30A	- J623-Engine control unit	87
F15	- SB15 - Fuse 15 on fuse holder B	10A	- J533-Data bus diagnostic interface	30
F16	- SB16 - Fuse 16 on fuse holder B	10A* 15A	- J299-Secondary air pump relay (BSE, BSF) N18-Exhaust gas recirculation valve** N75-Charge pressure control solenoid valve** N249-Turbocharger air recirculation valve** N316-Intake manifold flap valve (BMR, BUZ) N345-Exhaust gas recirculation cooler change-over valve** Z19-Lambda probe heater (BLY, BLF, BLR, BLX, BVX, BVY, BVZ) Z28-Lambda probe 2 heater (BLR, BLX, BVX, BVY, BLF)	87
F17	- SB17 - Fuse 17 on fuse holder B		- -Vacant	
F18	- SB18 - Fuse 18 on fuse holder B		- -Vacant	
F19	- SB19 - Fuse 19 on fuse holder B	30A	- R12-Amplifier -Special vehicles	30

* - engine codes BLY, BLF, BLR, BLX, BVX, BVY, BVZ only

** - diesel engines only

Passat**Fitting Locations****No. 201 / 23**

No.	Current Flow Diagram designation	Nominal value	Function/component	Terminal
F20	- SB20 - Fuse 20 on fuse holder B	5A* 15A	- G476-Clutch position sender (BSE, BSF, BLF, BMP, BKC, BMA, BKP, BVE, BVW, BLS, BMR, BUZ) N276-Fuel pressure regulating valve (BLF, BLR, BLX, BLY, BVX, BVY, BVZ)	87
F21	- SB21 - Fuse 21 on fuse holder B	20A	- J364 -Auxiliary heater control unit	30
F22	- SB22 - Fuse 22 on fuse holder B	30A	- J400-Wiper motor control unit	30
F23	- SB23 - Fuse 23 on fuse holder B	10A	- F265-Map-controlled engine cooling system thermostat (BLR, BLX, BLY, BVX, BVY, BVZ) J293 -Radiator fan control unit N80-Activated charcoal filter system solenoid valve 1 (BLF, BLR, BLX, BLY, BVX, BVY, BVZ, BSE, BSF) N156-Variable intake manifold change-over valve (BLF, BLR, BLX, BLY, BVX, BVY, BVZ) N205-Inlet camshaft control valve 1 (BLF, BLR, BLX, BLY, BVX, BVY, BVZ) N316 -Intake manifold flap valve (BLF, BSE, BSF) V157 -Intake manifold flap motor (BKC, BMA, BKP, BVE, BVW) Z19-Lambda probe heater (BLS)	87

* - engine codes BLY, BLF, BLR, BLX, BVX, BVY, BVZ only

** - diesel engines only

Passat**Fitting Locations****No. 201 / 24**

No.	Current Flow Diagram designation	Nominal value	Function/component	Terminal
F24	- SB24 - Fuse 24 on fuse holder B	10A ** 15A	- J583-NOx sensor control unit (BLX, BVY) Z19-Lambda probe heater (BLS, BMP, BMR, BUZ, BSE, BSF, BLY, BVZ) Z29-Lambda probe 1 heater after catalytic converter (BSE, BSF, BLY, BVZ, BMP, BUZ, BLR, BLX, BVX, BVY) Z30-Lambda probe 2 heater after catalytic converter (BLR, BLX) Z64-Lambda probe heater 3, after catalytic converter (BLR, BVY)	87
F25	- SB25 - Fuse 25 on fuse holder B	40A	- J519-Onboard power supply control unit	30
F26	- SB26 - Fuse 26 on fuse holder B	40A	- J519-Onboard power supply control unit	30
F27	- SB27 - Fuse 27 on fuse holder B	60A	- Z2 -Heated windscreen	30
F28	- SB28 - Fuse 28 on fuse holder B	40A 50A*	- V101-Secondary air pump motor (BSE, BSF) J179-Automatic glow period control unit*	30
F29	- SB29 - Fuse 29 on fuse holder B	50A	- J519-Onboard power supply control unit	30
F30	- SB30 - Fuse 30 on fuse holder B	50A	- J519-Onboard power supply control unit	30

* - diesel engines only

** - engine codes BLY, BLR, BVY, BVZ, BKC, BLS, BMP, BMR, BUZ only

Passat

Fitting Locations

No. 201 / 25

Position of relays and fuses

Position of fuses (SC) in fuse holder, left dash panel

Fuse colours

- 30 A - green
- 25 A - white
- 20 A - yellow
- 15 A - blue
- 10 A - red
- 7,5 A - brown
- 5 A - beige
- 3 A - purple

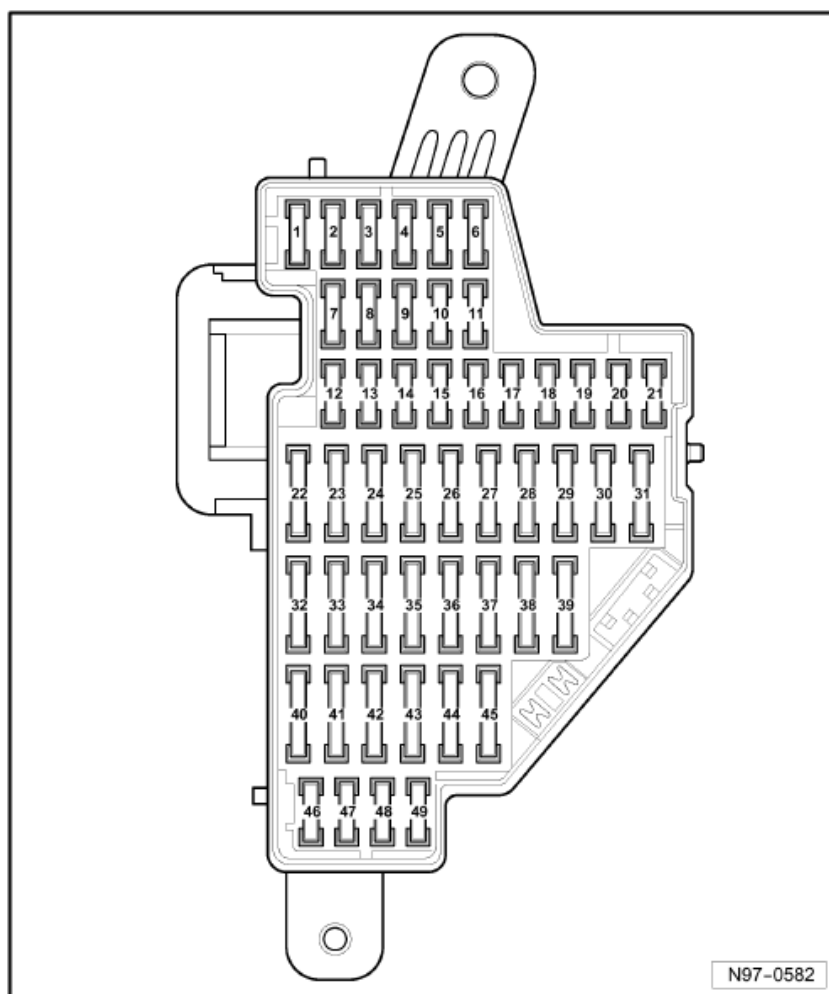

Passat**Fitting Locations****No. 201 / 26**

No.	Current Flow Diagram designation	Nominal value	Function/component	Terminal
1	- SC1 - Fuse 1 on fuse holder C	10A	- T16 -Diagnosis connection	15
2	- SC2-Fuse 2 on fuse holder C	5A	- E256-TCS and ESP button E540 -auto-hold button	15
3	- SC3 - Fuse 3 on fuse holder C	5A	- J500-Power steering control unit	15
4	- SC4 - Fuse 4 on fuse holder C	5A	- F -Brake light switch	15
5	- SC5-Fuse 5 on fuse holder C	10A	- E102 -Headlight range control regulator J667 -Power output module for left headlight (only models with gas discharge headlights) V48 -Left headlight range control motor V49 -Right headlight range control motor	15
6	- SC6 - Fuse 6 on fuse holder C	5A	- J345-Trailer detector control unit	15
7	- SC7 - Fuse 7 on fuse holder C	5A	- J285-Control unit with display in dash panel insert J533-Data bus diagnostic interface	15
8	- SC8 - Fuse 8 on fuse holder C	5A	- E149 - Rear roller blind switch (up to May 2005) E284 - Garage door operating unit (up to May 2005) J262 - Rear roller blind control unit (up to May 2005) Y7 - Automatic anti-dazzle interior mirror	15
9	- SC9 - Fuse 9 on fuse holder C	10A	- J492-Four-wheel drive control unit	15
10	- SC10 - Fuse 10 on fuse holder C	5A	- J271-Motronic current supply relay (BSE, BSF) J623-Engine control unit J670-Motronic current supply relay 2 (AXZ, BLV)	15
11	- SC11 - Fuse 11 on fuse holder C	5A	- E497-Accident data recorder button (police) G41-Taxi meter (taxi) G511-Mirror taxi meter (taxi) J754-Accident data memory -Coupling point tachograph (police) -Coupling point special signal system (police)	15

Passat**Fitting Locations****No. 201 / 27**

No.	Current Flow Diagram designation	Nominal value	Function/component	Terminal
12	- SC12 - Fuse 12 on fuse holder C	10A	- J386 - Driver door control unit J389 - Rear right door control unit (from May 2006)	30
13	- SC13 - Fuse 13 on fuse holder C	10A	- E1 -Light switch T16 -Diagnosis connection	30
14	- SC14 - Fuse 14 on fuse holder C	5A	- J764 -Electronic steering column lock control unit	30
15	- SC15 - Fuse 15 on fuse holder C	5A	- J519-Onboard power supply control unit (30g)	30
16	- SC16 - Fuse 16 on fuse holder C	10A	- D9 -Electronic ignition lock	30
17	- SC17 - Fuse 17 on fuse holder C	10A	- G303 -Interior monitor send and receive module 1 G397 -Rain and light detector sensor G384 -Vehicle inclination sender H12 -Alarm horn R149 -Remote control receiver for auxiliary coolant heater	30
18	- SC18 - Fuse 18 on fuse holder C	-	- -Vacant	
19	- SC19 - Fuse 19 on fuse holder C	-	- -Vacant	
20	- SC20 - Fuse 20 on fuse holder C	-	- -Vacant	
21	- SC21 - Fuse 21 on fuse holder C	-	- -Vacant	
22	- SC22 - Fuse 22 on fuse holder C	10A 5A	- G70 -Air mass meter (diesel engines and AXX, BPY, BWA) J49 -Electric fuel pump 2 relay (BSE, BSF)	15

Passat**Fitting Locations****No. 201 / 28**

No.	Current Flow Diagram designation	Nominal value	Function/component	Terminal
23	- SC23 - Fuse 23 on fuse holder C	10A	- N79 -Heater element for crankcase breather (cold countries)	15
24	- SC24 - Fuse 24 on fuse holder C	5A 20A*	- F4 -Reversing light switch F125 -Multifunction switch J217 -Automatic gearbox control unit J743 -Mechatronics for double clutch gearbox	15
25	- SC25 - Fuse 25 on fuse holder C	10A	- N... - Injectors (BSE, BSF) ** E284 - Garage door operating unit (up to April 2006)	15
26	- SC26 - Fuse 26 on fuse holder C	10A	- E149 -Rear roller blind switch (from May 2005) J262 -Rear roller blind control unit (from May 2005)	15
27	- SC27 - Fuse 27 on fuse holder C	5A	- J13 -Fresh air blower relay (only Climatic with auxiliary coolant heater) J255-Climatronic control unit (without auxiliary coolant heater)	15
28	- SC28 - Fuse 28 on fuse holder C	20A	- J345 - Trailer detector control unit ***	30
29	- SC29 - Fuse 29 on fuse holder C	20A	- J345 - Trailer detector control unit (left tail light, brake light, right/left turn signal) (up to April 2006) J540 - Control unit for electromechanical parking brake ***	30
30	- SC30 - Fuse 30 on fuse holder C	15A	- J345 - Trailer detector control unit (right tail light, rear fog light, reversing lights) (up to April 2006) J540 - Control unit for electromechanical parking brake ***	30
31	- SC31 - Fuse 31 on fuse holder C	25A	- J345 - Trailer detector control unit (up to April 2006) J17 - Fuel pump relay J49 - Electric fuel pump 2 relay	30

* - only for automatic gearbox

** - only models up to November 2005

*** - only models from May 2006

Passat**Fitting Locations****No. 201 / 29**

No.	Current Flow Diagram designation	Nominal value	Function/component	Terminal
32	- SC32 - Fuse 32 on fuse holder C	30A	- J519-Onboard power supply control unit (heated rear window)	30
33	- SC33-Fuse 33 on fuse holder C	20A	- J245-Sliding sunroof adjustment control unit	30
34	- SC34 - Fuse 34 on fuse holder C	15A	- G6-Fuel system pressurisation pump (BKC, BLS, BMP, BVW, BKP, BMA, BVE, BVD, BMR, BUZ)	30
35	- SC35 - Fuse 35 on fuse holder C	30A	- J39 -Headlight washer system relay V11 -Headlight washer system pump	30
36	- SC36 - Fuse 36 on fuse holder C	20A	- J485 -Auxiliary heater operation relay (not Climatronic)	30
37	- SC37 - Fuse 37 on fuse holder C	25A	- J774 -Heated front seats control unit	30
38	- SC38 - Fuse 38 on fuse holder C	15A	- J345-Trailer detector control unit **	30
39	- SC39 - Fuse 39 on fuse holder C	40A	- J126 - Fresh air blower control unit (Climatronic) J301 - Air conditioning system control unit (Climatic) **	30
40	- SC40 - Fuse 40 on fuse holder C	5A	- E1 - Lighting switch	75
41	- SC41 - Fuse 41 on fuse holder C	40A* 15A	- V2 - Fresh air blower (Climatic) * J13 - Fresh air blower relay * U1 - Cigarette lighter ** U9 - Rear cigarette lighter **	75
42	- SC42 - Fuse 42 on fuse holder C	15A	- V59 -Windscreen and rear window washer pump V12 -Rear window wiper motor	75

* - only models up to April 2006

** - only models from May 2006

Passat**Fitting Locations****No. 201 / 30**

No.	Current Flow Diagram designation	Nominal value	Function/component	Terminal
43	- SC43 - Fuse 43 on fuse holder C	20A	- J364 -Auxiliary heater control unit (only with second battery)	30
44	- SC44 - Fuse 44 on fuse holder C	20A	- J485 -Auxiliary heater operation relay (only with second battery)	30
45	- SC45 - Fuse 45 on fuse holder C	25A	- U5-12 V socket (police) U19-12 V socket 3 (taxi) *	30
46	- SC46 - Fuse 46 on fuse holder C	5A	- E72-2-way radio switch (police) E489-Engine continues to run without key button (police) J754-Accident data memory (taxi, police) * -Coupling point tachograph	30
47	- SC47 - Fuse 47 on fuse holder C	15A	- G41 - Taxi meter (taxi) * G511 - Mirror taxi meter (taxi) * K222 - Taxi roof sign warning lamp (taxi) * K224 - Interior light warning lamp (taxi) * L128 - Taxi silent alarm bulb (taxi) * L180 - Button illumination lamp for active alarm (taxi) * W18 - Luggage compartment light on left (police) - Coupling point two-way radio in luggage compartment (police) - Coupling point glove box (taxi) * - Coupling point luggage compartment (taxi) *	30
48	- SC48 - Fuse 48 on fuse holder C	20A	- - Coupling point loading device (police)	75
49	- SC49 - Fuse 49 on fuse holder C		- -Vacant	

* - only models with taxi equipment from May 2005

Passat

Fitting Locations

No. 201 / 31

Position of relays and fuses

Position of fuses (SD) in fuse holder, right dash panel

Fuse colours

- 30 A - green
- 25 A - white
- 20 A - yellow
- 15 A - blue
- 10 A - red
- 7,5 A - brown
- 5 A - beige
- 3 A - purple



Note:

Plug position SD11 has been dropped.

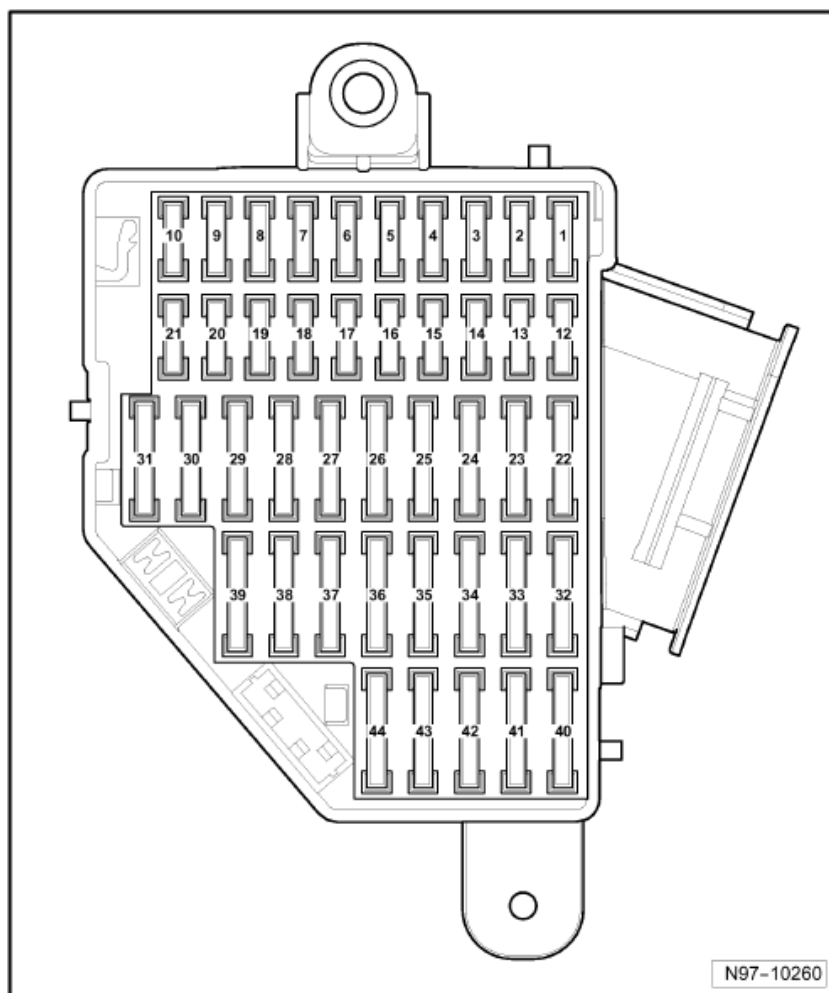

N97-10260

Passat**Fitting Locations****No. 201 / 32**

No.	Current Flow Diagram designation	Nominal value	Function/component	Terminal
1	- SD1 - Fuse 1 on fuse holder D	5A	- G197-Magnetic field sender for compass*	15
2	- SD2 - Fuse 2 on fuse holder D	5A	- J540-Electric park and handbrake control unit J104- ABS control unit	15
3	- SD3 - Fuse 3 on fuse holder D	5A	- G197 - Magnetic field sender for compass ** J446 - Parking aid control unit	15
4	- SD4 - Fuse 4 on fuse holder D	5A	- J428-Adaptive cruise control unit	15
5	- SD5 - Fuse 5 on fuse holder D	10A	- J668-Power output module for right headlight (only models with gas discharge headlights)	15
6	- SD6 - Fuse 6 on fuse holder D	5A	- F189-Tiptronic switch	15
7	- SD7 - Fuse 7 on fuse holder D	5A	- J745 -Cornering light and headlight range control unit (only models with gas discharge headlights)	15
8	- SD8 - Fuse 8 on fuse holder D	5A	- G65 -High pressure sender G266-Oil level and oil temperature sender	15
9	- SD9-Fuse 9 on fuse holder D	10A	- K145 -Front passenger side airbag deactivated warning lamp J234 -Airbag control unit J706 -Seat occupied recognition control unit	15
10	- SD10 - Fuse 10 on fuse holder D	5A	- J538-Fuel pump control unit (BLF, BLR, BLY, AXX, BPY, BLX, BVX, BVY, BVZ, BWA)	15
11	- SD11 - Fuse 11 on fuse holder D		- -Vacant	
12	- SD12-Fuse 12 on fuse holder D	10A	- J387 - Front passenger door control unit J389 - Rear right door control unit ***	30

* - only models from May 2005

** - only models up to April 2006

*** - only models from May 2006

Passat**Fitting Locations****No. 201 / 33**

No.	Current Flow Diagram designation	Nominal value	Function/component	Terminal
13	- SD13 - Fuse 13 on fuse holder D	10A	- J446 - Parking aid control unit **	30
14	- SD14 - Fuse 14 on fuse holder D	10A	- J714-Power latching system relay	30
15	- SD15 - Fuse 15 on fuse holder D	5A	- J255 -Climatronic control unit J301 -Air conditioning system control unit	30
16	- SD16 - Fuse 16 on fuse holder D	5A	- F189-Tiptronic switch	30
17	- SD17 - Fuse 17 on fuse holder D	5A	- K213-Electric parking brake and handbrake warning lamp J104-ABS control unit	30
18	- SD18 - Fuse 18 on fuse holder D		- -Vacant	
19	- SD19 - Fuse 19 on fuse holder D		- -Vacant	
20	- SD20 - Fuse 20 on fuse holder D		- -Vacant	
21	- SD21 - Fuse 21 on fuse holder D		- -Vacant	
22	- SD22 - Fuse 22 on fuse holder D	30A	- U13 -AC/DC converter with socket, 12 V - 230 V, 12 V-230 V U27 -Transformer with socket, 12 V-115 V *	30
23	- SD23 - Fuse 23 on fuse holder D	30A	- J388-Rear left door control unit J389-Rear right door control unit	30
24	- SD24 - Fuse 24 on fuse holder D	30A	- J762-Power latching control unit for rear left door (Variant)	30

* - american markets only

** - only models up to April 2006

Passat**Fitting Locations****No. 201 / 34**

No.	Current Flow Diagram designation	Nominal value	Function/component	Terminal
25	- SD25 - Fuse 25 on fuse holder D	30A	- J763-Power latching control unit for rear right door (Variant)	30
26	- SD26 - Fuse 26 on fuse holder D		- -Vacant	
27	- SD27 - Fuse 27 on fuse holder D	25A	- J786 -Heated backrest control unit	30
28	- SD28 - Fuse 28 on fuse holder D	15A	- J538 - Fuel pump control unit (AXZ, BLV) *	30
29	- SD29 - Fuse 29 on fuse holder D	30A	- J386-Driver door control unit J387-Front passenger side door control unit	30
30	- SD30 - Fuse 30 on fuse holder D	20A	- J540 - Electric park and handbrake control unit * J393 - Convenience system central control unit **	30
31	- SD31 - Fuse 31 on fuse holder D	20A	- J540 - Electric park and handbrake control unit * J538 - Fuel pump control unit **	30
32	- SD32 - Fuse 32 on fuse holder D		- -Vacant	
33	- SD33 - Fuse 33 on fuse holder D	20A	- U5 - 12 V socket * U18 - 12 V socket 2 *	30
34	- SD34 - Fuse 34 on fuse holder D	15A	- J538 - Fuel pump control unit (AXX, BPY, BLF, BLR, BLY, BLX, BVX, BVY, BVZ, BWA) *	30
35	- SD35 - Fuse 35 on fuse holder D	20A	- U1 - Cigarette lighter * U9 - Rear cigarette lighter *	30
36	- SD36 - Fuse 36 on fuse holder D		- -Vacant	

* - only models up to April 2006

** - only models from May 2006

Passat**Fitting Locations****No. 201 / 35**

No.	Current Flow Diagram designation	Nominal value	Function/component	Terminal
37	- SD37 - Fuse 37 on fuse holder D		- -Vacant	
38	- SD38 - Fuse 38 on fuse holder D		- U5 - 12 V socket **	75
39	- SD39 - Fuse 39 on fuse holder D	10A	- E94 - Heated driver seat regulator *** E95 -Heated front passenger seat regulator *** E128 - Heated rear left seat switch with regulator *** E129 - Heated rear right seat switch with regulator *** J255 - Climatronic control unit J301 - Air conditioning system control unit J713 - Second battery charging circuit relay Z20 - Left washer jet heater element Z21 - Right washer jet heater element	75
40	- SD40 - Fuse 40 on fuse holder D	5A	- J754-Accident data memory (taxi) *	
41	- SD41 - Fuse 41 on fuse holder D	15A	- G41-Taxi meter (taxi) * G511-Mirror taxi meter (taxi) * K222-Taxi roof sign warning lamp (taxi) * K224-Interior light warning lamp (taxi) * L180-Button illumination lamp for active alarm (taxi) * -Coupling point glove compartment (taxi) * -Coupling point luggage compartment (taxi) *	30

* - only models with taxi equipment up to May 2005

** - only models from May 2006

*** - only models up to April 2006

Passat**Fitting Locations****No. 201 / 36**

No.		Current Flow Diagram designation	Nominal value	Function/component	Terminal
42	-	SD42 - Fuse 42 on fuse holder D	20A	-Coupling point glove compartment (taxi) *	30
43	-	SD43 - Fuse 43 on fuse holder D	5A	- J601-Taxi alarm remote control, control unit (taxi) * -Coupling point special signal system (police) -Coupling point glove compartment (taxi) ** -Coupling point luggage compartment (taxi) **	30
44	-	SD44 - Fuse 44 on fuse holder D	10A	- J601-Taxi alarm remote control, control unit (taxi) ** U19-12 V socket -3- (taxi) * -Coupling point special signal system (police)	30

* - only models with taxi equipment up to May 2005

** - only models with taxi equipment from May 2005

Passat**Fitting Locations****No. 201 / 37****Relay locations on electronics box, in left engine compartment (box high)**

- A1 - Vacant
- A2 - Circulation pump relay - J160 (100)
- A3 - Motronic current supply relay 2 - J670 (167)
- A4 - Motronic current supply relay - J271 (458) (petrol)
- A4 - Terminal 30 voltage supply relay - J317 (458) (diesel)

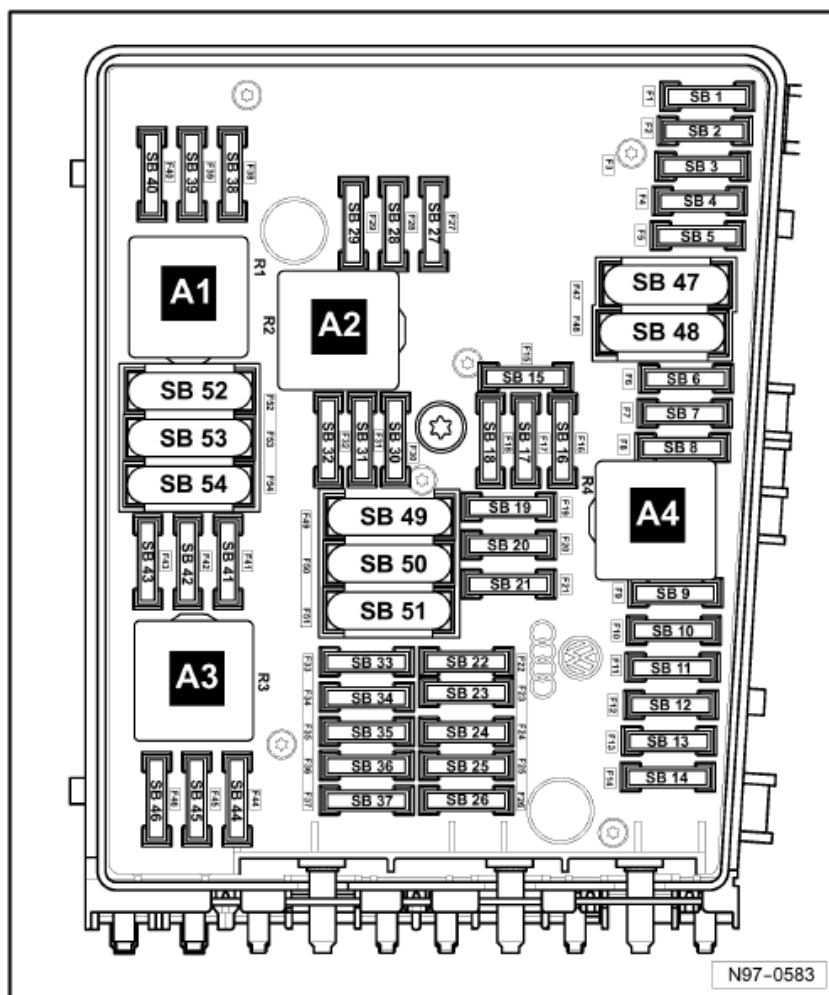

Passat**Fitting Locations****No. 201 / 38****Relay locations on electronics box, in left engine compartment (box low)**

- A1 - Secondary air pump relay - J299 (100) (BSE, BSF)
- A2 - Motronic current supply relay - J271 (458) (petrol)
- A2 - Terminal 30 voltage supply relay - J317 (458) (diesel)

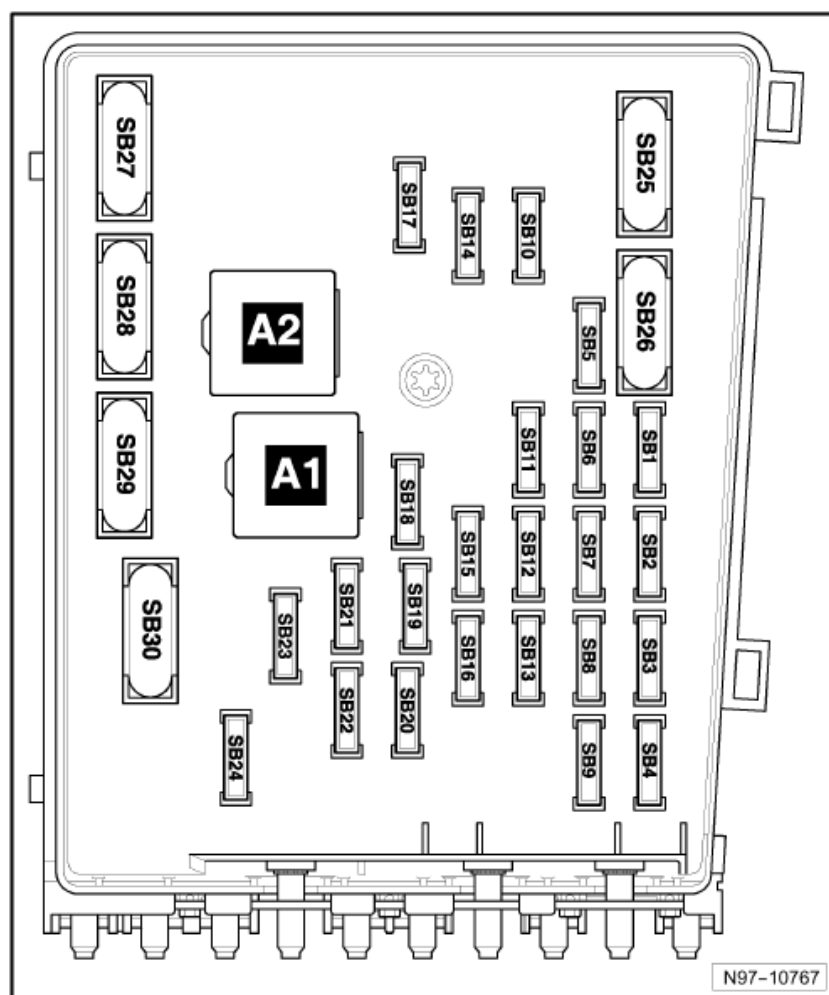

Passat

Fitting Locations

No. 201 / 39

Relay position assignment on additional relay carrier under electronics box in left engine compartment (up to November 2005)

C1 - Vacant

C2 - Automatic glow period
control unit J179 (461)

C3 - Vacant

C4 - Vacant

C5 - Vacant

C6 - Vacant

**Note:**

The additional relay carrier is located under the electronics box and is only visible when the box is removed.

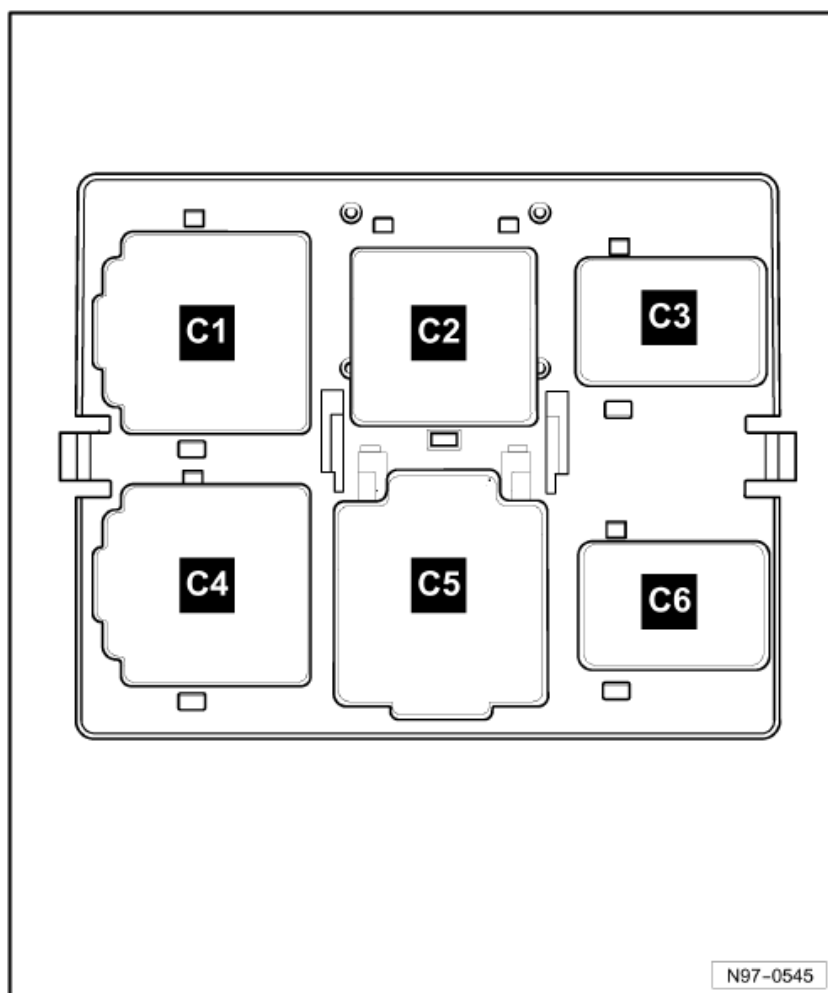

Passat**Fitting Locations****No. 201 / 40****Relay position assignment on additional relay carrier under electronics box in left engine compartment (from November 2005)****Automatic glow period control unit - J179**

- 1 - Additional relay carrier, under electronics box in engine compartment, left
- 2 - J179-Automatic glow period control unit

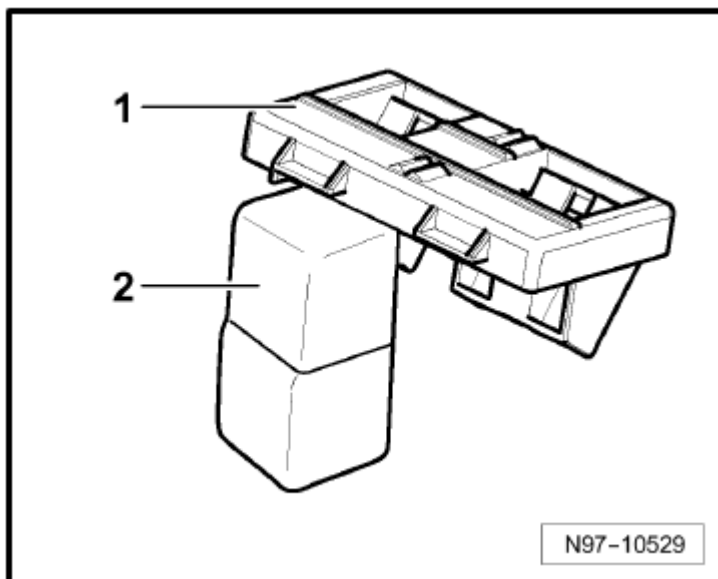

Passat

Fitting Locations

No. 201 / 41

Relay positions under left dash panel (relay carrier 1)

- 1 - Auxiliary heater operation relay - J485 (53)
- 2 - Vacant
- 3 - Fresh air blower relay - J13 (404) only with auxiliary coolant heater
- 4 - Fuel pump relay - J17 (404)
- 5 - Electric fuel pump 2 relay - J49 (404), diesel engines only
- 6 - Headlight washer system relay - J39- (53)
- 7 - Terminal 50 voltage supply relay - J682 (433)

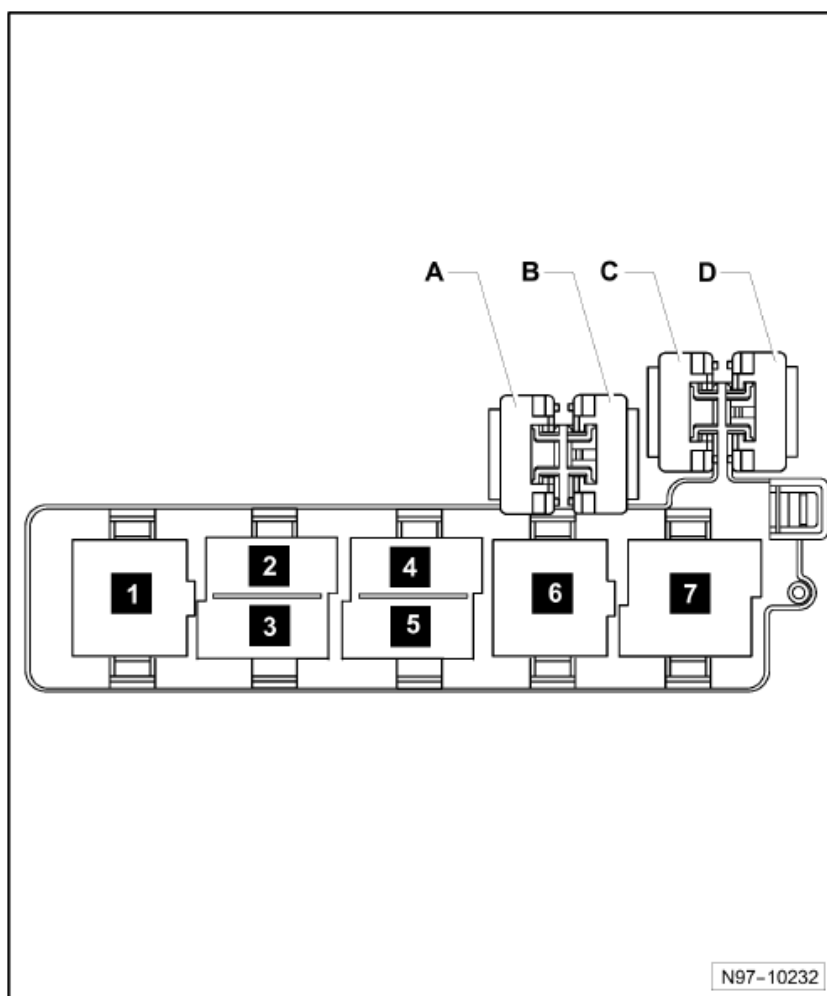

Passat

Fitting Locations

No. 201 / 42

Safety cutout, under left dash panel

A - S46 - Front passenger seat adjustment thermal fuse 1 (30A)

B - S44 - Driver seat adjustment thermal fuse 1 (15 A)

C - Vacant

D - Vacant

**Note:**

Vehicles with electrically adjustment seat and memory function dispose of a fuse (30A).

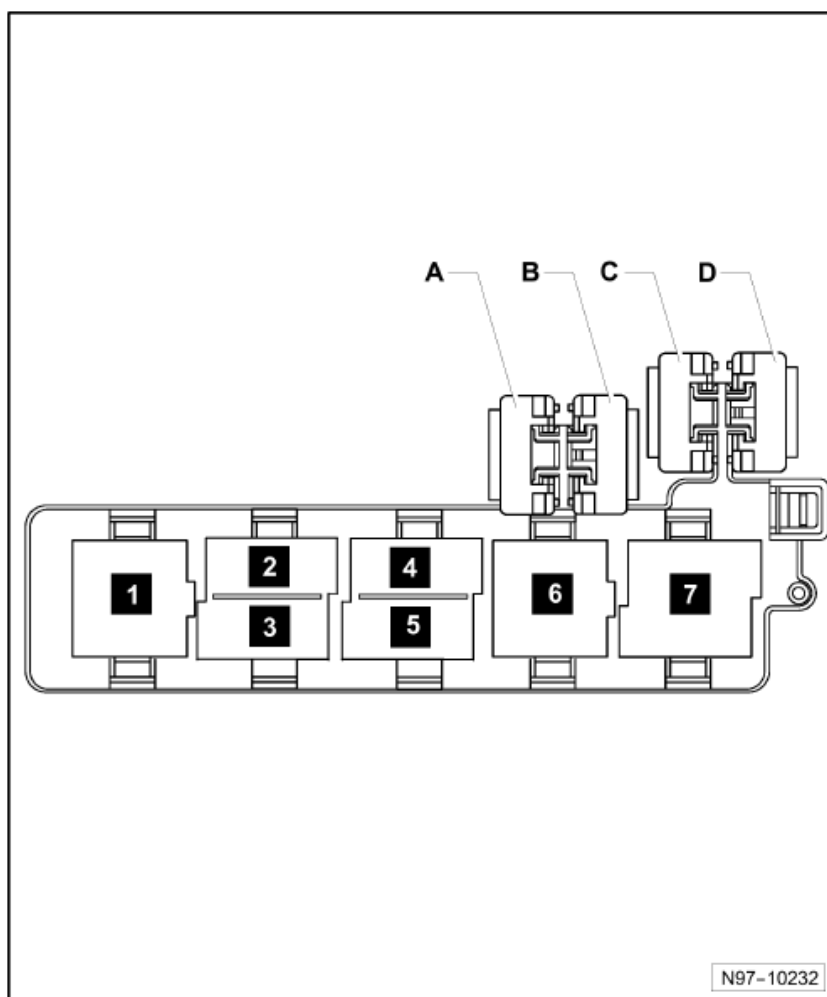

N97-10232

Passat**Fitting Locations****No. 201 / 43****Position of relays, relay carrier on onboard power supply control unit, driver footwell**

- B1 - Terminal 15 voltage supply relay - J329 (460)**
- B2 - Vacant**
- B3 - Vacant**
- B4 - Terminal 30 voltage supply relay 2 - J689 (449)**
- B5 - Heated rear window relay - J9 (53)**
- B6 - Dual tone horn relay - J4 (449)**
- B7 - Double washer pump relay 1 - J729 (404)**
- B8 - Double washer pump relay 2 - J730 (404)**
- B9 - X-contact relief relay - J59 (460)**

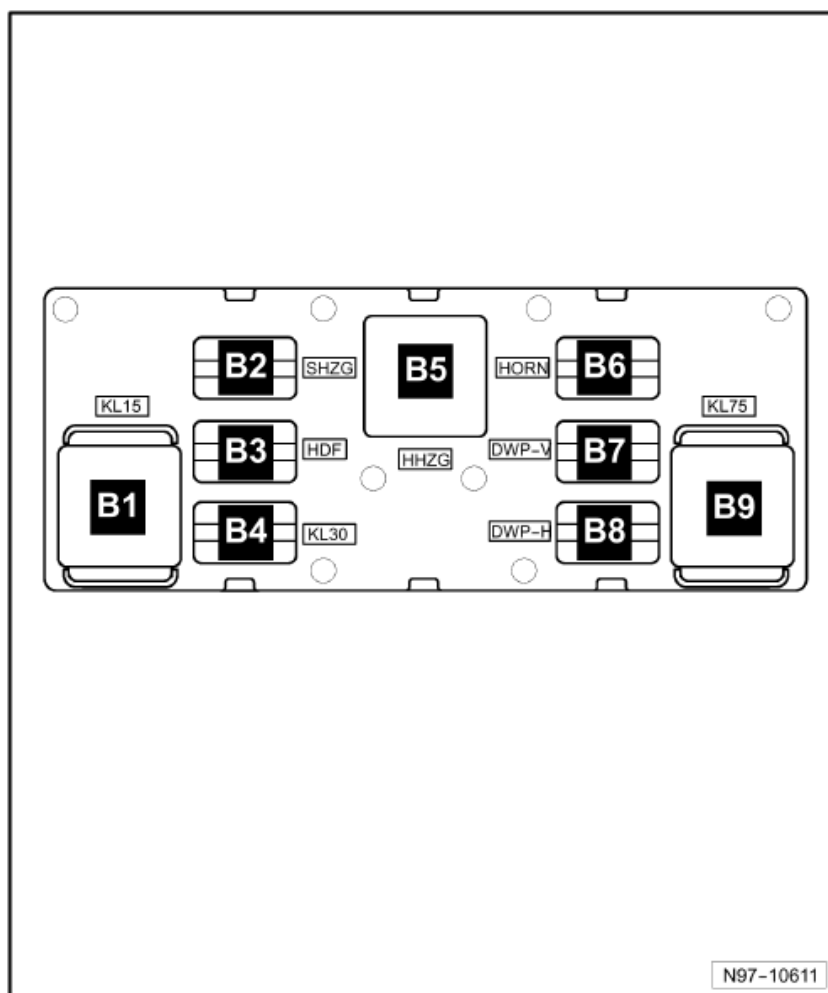

Passat

Fitting Locations

No. 201 / 44

Relay positions under left dash panel (relay carrier 2)

A - Drive train CAN bus
isolation relay- J788 (479)

B - Vacant

C - Second battery charging
circuit relay - J713 (478)

D - Alarm horn relay - J641
(53), american markets
only

Fuses in the fuse holder on
left under dash panel

1 - Vacant

2 - Vacant

3 - Vacant

4 - Vacant

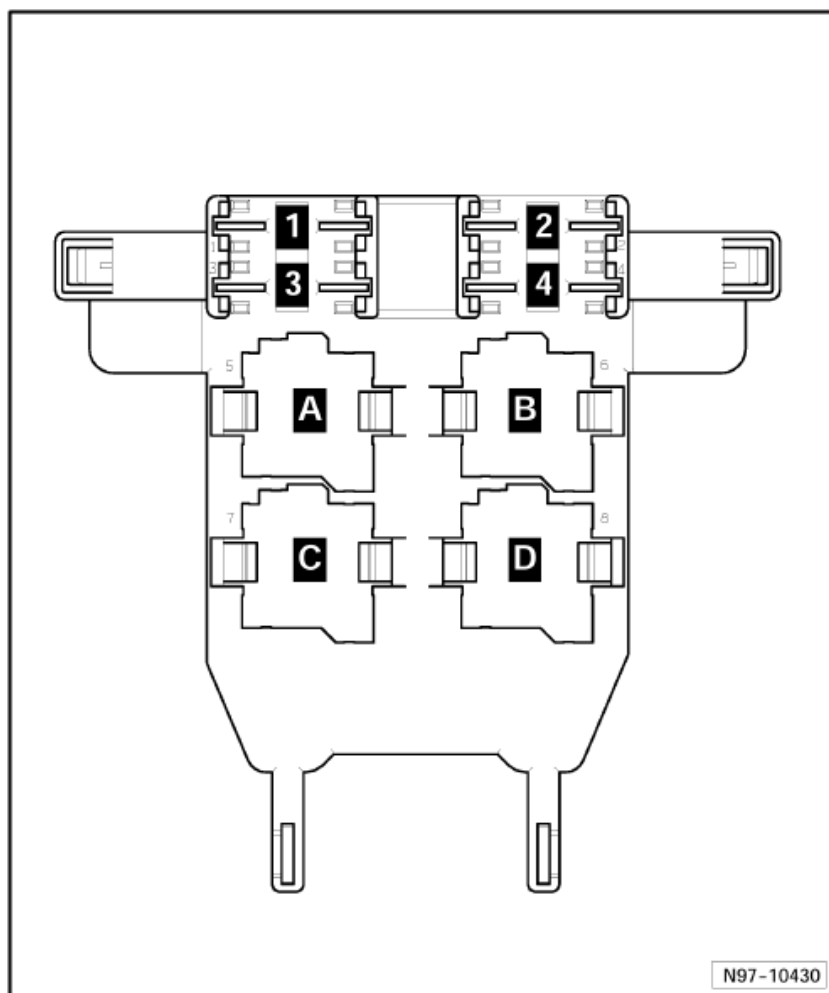

Passat

Fitting Locations

No. 201 / 45

Fuses (SF) on fuse holder, in luggage compartment, rear left (AXZ, BLV)

Torque settings

⇒ Electrical system, Repair Group 97, Removing and installing fuse holders

Fuse colours

- 30 A - green
- 25 A - white
- 20 A - yellow
- 15 A - blue
- 10 A - red
- 7,5 A - brown
- 5 A - beige
- 3 A - purple

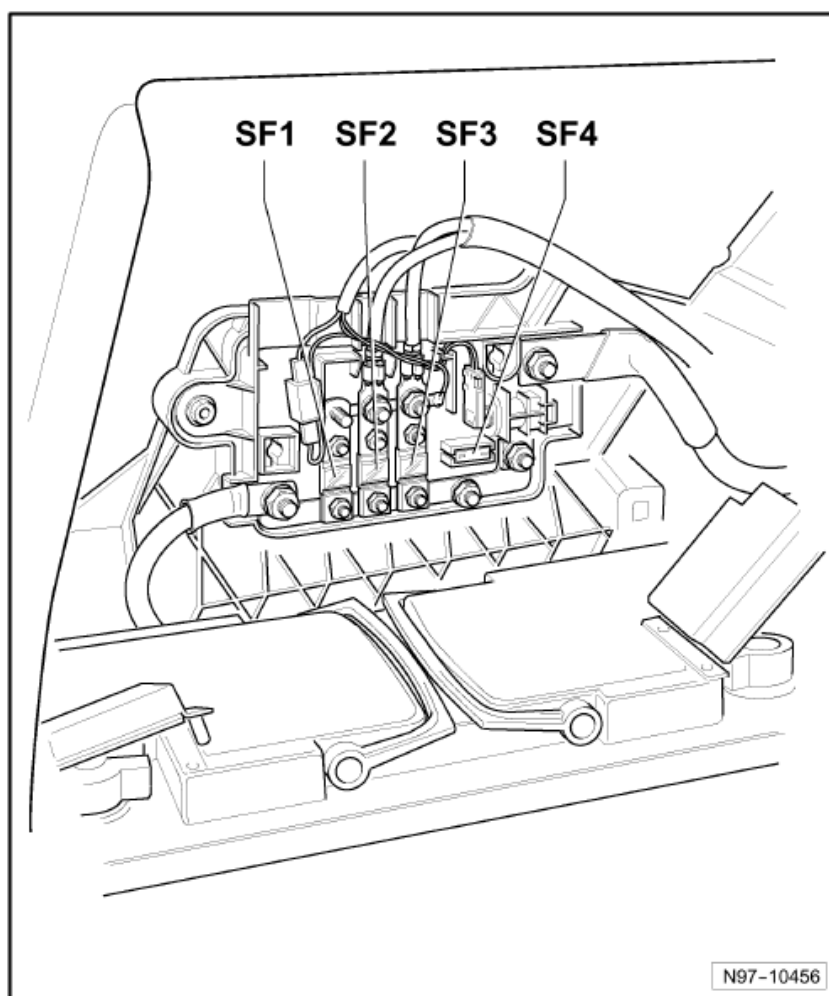

Passat**Fitting Locations****No. 201 / 46**

No.		Current Flow Diagram designation	Nominal value	Function/component	Terminal
1	-	SF1 - Fuse 1 on fuse holder F	30A	- Left fuse carrier (SC12 - SC17, SC29 - SC31) * - Right fuse carrier (SD12 - SD17, SD28, SD29 - SD31) *	30
2	-	SF2 - Fuse 2 on fuse holder F	80A	-Fuses in electronics box (SB16 - SB26, SB49, SB50)	30
3	-	SF3 - Fuse 3 on fuse holder F	125A	-Voltage supply electronics box	30
4	-	SF4 - Fuse 4 on fuse holder F	5A	J519-Onboard power supply control unit	30

* - only models from May 2006

Passat

Fitting Locations

No. 201 / 47

Terminal 30 wiring junction - TV2

Location:

In engine compartment, front left ⇒ -Arrow -

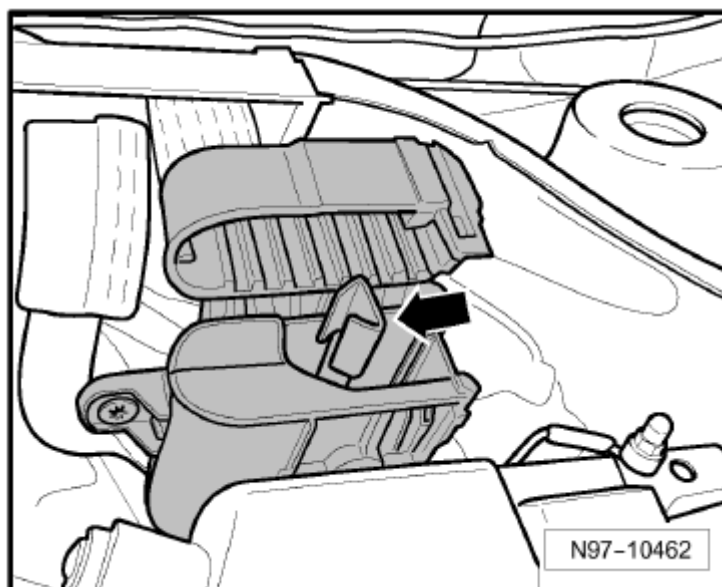

Passat

Fitting Locations

No. 201 / 48

Fuse 2 (30) - S205

Location:

in luggage compartment, left, behind side trim
⇒ -Arrow -

Fuse rating 70 ampere (saloon models)

Fuse rating 60 ampere (Variant)

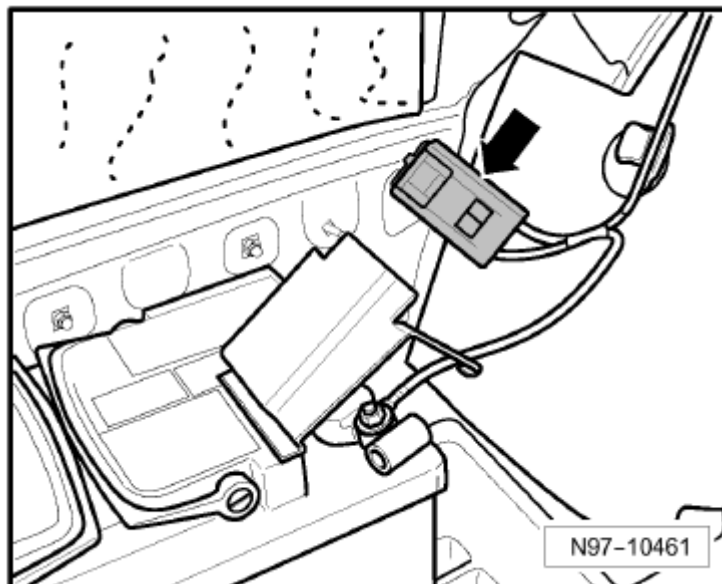

Passat

Fitting Locations

No. 201 / 49

Heated windscreen relay - J47

Location:

in plenum chamber next to engine control unit

⇒ -Arrow -

